

GEAR BOX COMPONENT

0500V26	1 *	GEAR BOX
0510V26	1 *	GEAR BOX COVER 303243
0520V26	1 *	GEAR
0521V26	1 *	GEAR
0530V26	1 *	SCREW NUT
0531V26	1 *	SCREW NUT
0540V26	1 *	GEAR 303245
0550V26	1 *	GEAR SHAFT
0560V26	1 *	SHAFT COVER
0570V26	1 *	GEAR 303244
0580V26	1 *	MAIN SHAFT
0591V26	1 *	MAIN SHAFT COVER
0600V26	1 *	SPEED CHANGING SHAFT
0610V26	1 *	SPEED CHANGING ARM
0611V26	1 *	SHAFT STOPPER
0612V26	1 *	SPRING
0620V26	1 *	SLIDE BLOCK
0630V26	1 *	CLUTCH
0631V26	2 *	BRASS BRACKET
0632V26	1 *	BRASS BRACKET
G6008V	1 *	BALL BEARING
G6206V	1 *	BALL BEARING
G6303V	1 *	BALL BEARING
G6304V	1 *	BALL BEARING
L4030V	1 *	OIL SEAL
L5230V	1 *	OIL SEAL
L5840V	1 *	OIL SEAL
CP0500V	1	GEAR BOX COMPLETE 303242
0700V26	1	SPEED CHANGING LEVER
0740V26	1	SHAFT HOUSING

0790V26	1	SPEED LEVER RIGHT
7071V26	1	PULLEY 303228
9220V26	1	LEVER KNOB
BA44V26	2	V-BELT, 7071+7300 (60HZ)
BA45V26	2	V-BELT, 7071+7300 (50HZ)

WORK TABLE COMPONENT

1010V26	1	WORK TABLE
1020V26	1	TABLE SUPPORT FRAME
1080V26	2	BLADE GUARD

GUIDE POST COMPONENT

1311V26	1	GUIDE SUPPORT, UPPER
1312V26	1	GUIDE SUPPORT, LOWER
1320V26	4	BLADE GUIDE 303233
1331V26	1	BLADE STOPPER, LONG 303251
1332V26	1	BLADE STOPPER, SHORT 303263
1333V26	1	ECCENTRIC SHAFT
1350V26	1	BLADE GUIDE POST
1351V26	1	GEAR BAR
1360V26	1	GUIDE POST HOUSING
1370V26	1	BLADE GUARD, LEFT
1380V26	1	BLADE GUARD, RIGHT
1400V26	2	SPRING
1410V26	1	SPRING HOUSING
1440V26	1	POST HOUSING SPRING
1450V26	1	POST ELEVATING GEAR
1650V26	1	CIRCLE CUTTING ATTACHMENT
9015V26	1	GUIDE POST LOCK
9033V26	1	POST ELEVATE HANDWHEEL
9230V26	1	HANDLE KNOB
G6201V26	1	BALL BEARING

MAIN DRIVE

2000V26	1	MAIN DRIVE MOTOR 303255
2011V26	1	MOTOR PULLEY
2020V26	4	MOTOR ROTARY SEAT
BA43V26	2	V-BELT, 2011+7070
BA60V26	1	V-BELT, 2011+4450

WHEEL COMPONENT

3010V26	1 *	LOWER WHEEL
3020V26	1 *	RUBBER TIRE 303261
CP3010V26	1	LOWER WHEEL COMPLETE
3030V26	1	TAPER SLEEVE
3040V26	1	WHEEL LOCKING NUT
3020V26	1 *	RUBBER TIRE
3050V26	1 *	UPPER WHEEL
G6305V26	2 *	BALL BEARING
CP3050V26	1	UPPER WHEEL COMPLETE
3060V26	1	UPPER WHEEL LOCK

WORK TABLE CONTINUED

1090V26	1	TABLE SUPPORT HOUSING
1100V26	1	GUIDE SUPPORT HOUSING
1120V26	1	RIGHT-HANDED SCREW
1140V26	1	LEFT-HANDED SCREW
1150V26	1	SLIDER
1160V26	1	TABLE TILT ADJUST SCREW
1500V26	1	METER GAUGE
1550V26	1	RIP FENCE + LOCK 303256
1800V26	1	FEED SCREW

WHEEL COMPONENT CONT.

3080V26	1 *	SLIDE BLOCK HOUSING
3090V26	1 *	SLIDE BLOCK SEAT
3100V26	2 *	SLIDE BLOCK GUIDE
3110AV26	1 *	UPPER WHEEL SLIDER
3116V26	1 *	SLIDER SCREW SHAFT
3120V26	1 *	WHEEL ELEVATE SHAFT
3121V26	1 *	SPRING
3150V26	1 *	WASHER
3180V26	3 *	INDICATOR RING
CP3080V26	1	SLIDE HOUSING COMPLETE
3190V26	1	TENSION INDICATOR
3200V26	1	WHEEL TILT ADJUSTER
3220V26	1	WHEEL TILT CONNECTER
3240V26	1	CONNECTER WASHER
3250V26	1	CONNECTER HOUSING
9030V26	1	HANDWHEEL
9060V26	1	TILT ADJUST HANDWHEEL

AIR PUMP COMPONENT

4060V26	2	AIR PUMP SEAT
4170V26	1	AIR NOZZLE
4180V26	1	AIR NOZZLE CLIPPER
4450V26	1	AIR COMPRESSOR 303229

VARIATOR COMPONENT

7000V26	1	MOTOR SPRING HOUSING
7010V26	1 *	SPRING
7020V26	1 *	VAEIATOR DISK, UPPER
7030V26	1 *	VAEIATOR DISK, UPPER
7040V26	1 *	VARIATOR HOUSING TUBE
7050V26	1 *	VARIATOR SHAFT
7060V26	1 *	VARIATOR HOUSING
G6007V26	1 *	BALL BEARING
G6205V26	2 *	BALL BEARING
CP7060V26	1	VARIATOR HOUSING
7070V26	1	PULLEY
7080V26	1	WORM GEAR
7090V26	1	WORM GEAR HOUSING
7100V26	1	GEAR SHAFT
7110V26	1	WORM
7120V26	1	WHIRLING ARM
7200V26	1 *	SPRING HOUSING
7210V26	1 *	SPRING
7220V26	1 *	VARIATOR DISK, LOWER
7230AV26	1 *	VARIATOR DISK, LOWER
7260V26	1 *	SHAFT HOUSING
G6007V26	1 *	BALL BEARING
G6204V26	1 *	BALL BEARING
CP7260V26	1	SHAFT HOUSING
7290V26	1	SPEED CHANGE WHEEL SEAT
7300V26	1	PULLEY

MAIN BODY & MISCELLANEOUS

5000V26	1	MAIN BODY
5100V26	1	REAR DOOR, LARGER
5101V26	1	REAR DOOR, SMALLER
5120V26	1	LOWER DOOR
5140V26	1	UPPER DOOR
8111V26	1	CONTROL PLATE
8372V26	1	VARIATOR INSTRUCTION
8422V26	1	GEAR BOX INSTRUCTION
8712V26	1	INDICATOR PLATE
8743V26	1	TILT INSTRUCTION
9300V26	2	UPPER DOOR HINGE
9310V26	6	HINGE
9500V26	4	SPRING PLATE
9590V26	2	HANDLE ARM

MAIN BODY & MISC. CONT.**VARIATOR COMPONENT CONT**

9600V26	1	CHIP STOPPER	7310V26	1	SPEED READOUT DETECTOR 303264
9700V26	1	INDICATE MIDDLE	7330V26	1	DIGITAL TACHOMETER 303238
9780V26	1	BRUSHER BRACKET	9030V26	1	HANDWHEEL
9790V26	1	CHIP BRUSHER 303237	BA44V26	-	V-BELT, 7071+7300 (60HZ)
9850V26	1	KEY FOR REAR DOOR	BA45V26	-	V-BELT, 7071+7300 (50HZ)
9880V26	1	CHIP COLLECTOR	BA43V26	-	V-BELT, 2011+7070
9900V26	1	MAGNIFYING GLASS	BV875V26	1	V-BELT

CONTROL SWITCH COMPONENT

6600V26	1	PUSH BUTTON, ON
6602V26	1	PUSH BUTTON, OFF,
6610V26	1	EMERGENCY SWITCH
6620V26	2	DOOR LIMIT SWITCH 303239
6650V26	1	KEY SWITCH
6700V26	1	MAIN POWER SWITCH
6713V26	2	MAGNETIC SWITCH 303254
6723V26	1	OVERLOAD STARTER 303258
6741V26	1	PILOT LAMP, GREEN
6745V6	1	VOLTAGE REDUCER 303266
6752V26	1	FUSE SEAT
6753V26	2	FUSE SEAT
6754V26	1	FUSE SEAT
6770V26	2	WIRE HOUSING
6771V26	1	GROUND SEAT
6798V26	1	ELECTRIC BOX
6799V26	1	WIRING PLATE

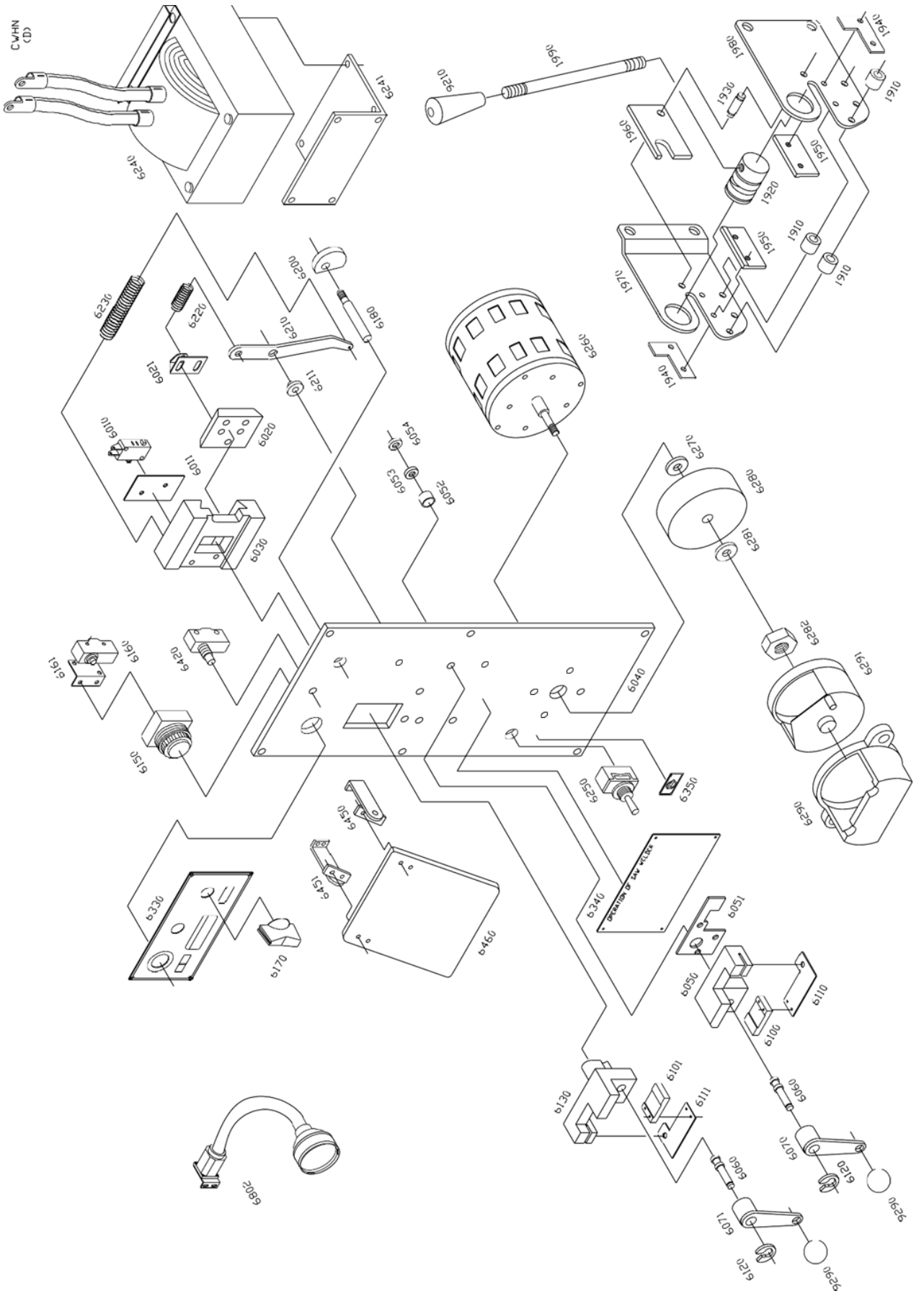

WELDER COMPONENT

6010V26	1 *	LIMIT SWITCH 303250
6011V26	1 *	INSULATOR
6020V26	1 *	GUIDE BLOCK
6040V26	1 *	HOUSING
6050V26	1 *	STATIONARY JAW
6051V26	1 *	INSULATOR
6052V26	3 *	INSULATING TUBE
6053V26	3 *	WASHER, INSULATE
6054V26	3 *	SPACER
6060V26	2 *	ECCENTRIC SHAFT
6070V26	1 *	CLAMP LEVER, RIGHT
6071V26	1 *	CLAMP LEVER, LEFT
6100V26	1 *	CLAMP SUPPORT, RIGHT
6101V26	1 *	CLAMP SUPPORT, LEFT
6110V26	1 *	CLAMP PLATE, RIGHT
6111V26	1 *	CLAMP PLATE, LEFT
6120V26	2 *	CAM
6130V26	1 *	MOVING JAW
6150V26	1 *	WELD BUTTON 303271
6160V26	1 *	MICRO SWITCH
6161V26	1 *	MICRO SWITCH BRACKET
6170V26	1 *	PRESSURE ADJUST KNOB
6180V26	1 *	SHAFT
6200V26	1 *	CAM
6210V26	1 *	WELD TENSION ARM
6211V26	1 *	BUSHING
6220V26	1 *	SPRING, SHORTER
6230V26	1 *	SPRING, LONGER
6240V26	1 *	TRANSFORMER (4.2KVA)
6241V26	1 *	MOUNTING BRACKET (4.2KVA ONLY)
6250V26	1 *	SWITCH
6260V26	1 *	GRINDER MOTOR
6270V26	1 *	SPACER
6280V26	1 *	GRINDER WHEEL 303248
6281V26	1 *	1/4" WASHER, FLAT
6282V26	1 *	6 mm-1.0 HEX NUT
6290V26	1 *	GRINDER GUARD 303247
6291V26	1 *	GRINDER COVER 303246
6330V26	1 *	WELDER NAME PLATE
6340V26	1 *	INSTRUCTION LABLE
6350V26	1 *	GRINDER LABLE
6420V26	1 *	ANNEAL BUTTON 303231
6450V26	1 *	DEFLECTOR BRACKET, RIGHT
6451V26	1 *	DEFLECTOR BRACKET, LEFT
6460V26	1 *	SPARK DEFLECTOR
9290V26	2 *	KNOB 303249
WCPV26	1	42-WELDER ASSEMBLY

WORK LAMP COMPONENT

6802V26	1 *	WORK LAMP COMPONENT 303272 Bulb MR 16 12v 20W
---------	-----	--

SHEAR COMPONENT

1910V26	3 *	SPINDLE BUSHING
1920V26	1 *	SPINDLE LIFT
1930V26	1 *	BLADE SHAFT
1940V26	2 *	VANED IRON PLATE
1950V26	2 *	LOWER BLADE
1960V26	1 *	UPPER BLADE
1970V26	1 *	JOINT PLATE, LEFT
1980V26	1 *	CHAIN JOINT, RIGHT
1990V26	1 *	HANDLE BAR
9210V26	1 *	KNOB
SCPV26	1	SHEAR COMPLETE 303234

