



**GEAR BOX COMPONENT**

0500	1 *	GEAR BOX
0510	1 *	GEAR BOX COVER <b>303243</b>
0520	1 *	GEAR
0521	1 *	GEAR
0530	1 *	SCREW NUT
0531	1 *	SCREW NUT
0540	1 *	GEAR <b>303245</b>
0550	1 *	GEAR SHAFT
0560	1 *	SHAFT COVER
0570	1 *	GEAR <b>303244</b>
0580	1 *	MAIN SHAFT
0591	1 *	MAIN SHAFT COVER
0600	1 *	SPEED CHANGING SHAFT
0610	1 *	SPEED CHANGING ARM
0611	1 *	SHAFT STOPPER
0612	1 *	SPRING
0620	1 *	SLIDE BLOCK
0630	1 *	CLUTCH
0631	2 *	BRASS BRACKET
0632	1 *	BRASS BRACKET
G6008	1 *	BALL BEARING
G6206	1 *	BALL BEARING
G6303	1 *	BALL BEARING
G6304	1 *	BALL BEARING
L4030	1 *	OIL SEAL
L5230	1 *	OIL SEAL
L5840	1 *	OIL SEAL
CP0500	1	GEAR BOX COMPLETE <b>303242</b>
0700	1	SPEED CHANGING LEVER
0740	1	SHAFT HOUSING
0790	1	SPEED LEVER RIGHT
7071	1	PULLEY <b>303228</b>
9220	1	LEVER KNOB
BA44	2	V-BELT, 7071+7300 (60HZ)
BA45	2	V-BELT, 7071+7300 (50HZ)

**WORK TABLE COMPONENT**

1011	1	WORK TABLE
1021	1	TABLE SUPPORT FRAME

**GUIDE POST COMPONENT**

1311	1	GUIDE SUPPORT, UPPER
1312	1	GUIDE SUPPORT, LOWER
1320	4	BLADE GUIDE <b>303233</b>
1331	1	BLADE STOPPER, LONG <b>303251</b>
1332	1	BLADE STOPPER, SHORT <b>303263</b>
1333	1	ECCENTRIC SHAFT
1350	1	BLADE GUIDE POST
1351	1	GEAR BAR
1360	1	GUIDE POST HOUSING
1370	1	BLADE GUARD, LEFT
1380	1	BLADE GUARD, RIGHT
1400	2	SPRING
1410	1	SPRING HOUSING
1440	1	POST HOUSING SPRING
1450	1	POST ELEVATING GEAR
1650	1	CIRCLE CUTTING ATTACHMENT
9015	1	GUIDE POST LOCK
9033	1	POST ELEVATE HANDWHEEL
9230	1	HANDLE KNOB
G6201	1	BALL BEARING

**MAIN DRIVE**

2000	1	MAIN DRIVE MOTOR <b>303255</b>
2011	1	MOTOR PULLEY
2020	4	MOTOR ROTARY SEAT
BA43	2	V-BELT, 2011+7070
BA60	1	V-BELT, 2011+4450

**WHEEL COMPONENT**

3010	1 *	LOWER WHEEL
3020	1 *	RUBBER TIRE <b>303261</b>
<b>CP3010</b>	<b>1</b>	<b>LOWER WHEEL COMPLETE</b>
3030	1	TAPER SLEEVE
3040	1	WHEEL LOCKING NUT
3020	1 *	RUBBER TIRE
3050	1 *	UPPER WHEEL
G6305	2 *	BALL BEARING
<b>CP3050</b>	<b>1</b>	<b>UPPER WHEEL COMPLETE</b>

1080	2	BLADE GUARD	3060	1	UPPER WHEEL LOCK
		<b>WORK TABLE CONT.</b>			<b>WHEEL COMPONENT CONT.</b>
			3080	1 *	SLIDE BLOCK HOUSING
1090	1	TABLE SUPPORT HOUSING	3090	1 *	SLIDE BLOCK SEAT
1100	1	GUIDE SUPPORT HOUSING	3100	2 *	SLIDE BLOCK GUIDE
1120	1	RIGHT-HANDED SCREW	3110A	1 *	UPPER WHEEL SLIDER
1140	1	LEFT-HANDED SCREW	3116	1 *	SLIDER SCREW SHAFT
1150	1	SLIDER	3120	1 *	WHEEL ELEVATE SHAFT
1160	1	TABLE TILT ADJUST SCREW	3121	1 *	SPRING
1230	4	BEARING COVER	3150	1 *	WASHER
1250	2	TABLE STROKING SHAFT	3180	3 *	INDICATOR RING
1501	1	METER GAUGE	CP3080	1	SLIDE HOUSING COMPLETE
1551	1	RIP FENCE + LOCK <b>303256</b>	3190	1	TENSION INDICATOR
1600	2	T-BLOCK	3200	1	WHEEL TILT ADJUSTER
1610	1	RIP FENCE SLIDE GUIDE	3220	1	WHEEL TILT CONNECTER
2500	1	TORQUE MOTOR	3240	1	CONNECTER WASHER
2501	1	TORQUE MOTOR SPEED REDUCER	3250	1	CONNECTER HOUSING
2510	1	WHEEL GEAR	9030	1	HANDWHEEL
2520	1	SLIDE GEAR	9060	1	TILT ADJUST HANDWHEEL
2530	1	TORQUE MOTOR HOUSING			
2610	1	SET RING SLIDE BAR			
2620	2	LIMITED SWITCH SET RING			
2650	1	LIMITED SWITCH HOUSING			
6165	2	LIMITED SWITCH			
9017	2	SET RING LOCK			
GLM35	4	LINER BEARING			

**AIR PUMP COMPONENT**

4060	2	AIR PUMP SEAT
4170	1	AIR NOZZLE
4180	1	AIR NOZZLE CLIPPER
4450	1	AIR COMPRESSOR <b>303229</b>
BA60	1	V-BELT, 2011+4450

**MAIN BODY & MISCELLANEOUS**

5000	1	MAIN BODY
5100	1	REAR DOOR, LARGER
5101	1	REAR DOOR, SMALLER

**VARIATOR COMPONENT**

7000	1	MOTOR SPRING HOUSING
7010	1 *	SPRING
7020	1 *	VAEIATOR DISK, UPPER
7030	1 *	VAEIATOR DISK, UPPER
7040	1 *	VARIATOR HOUSING TUBE
7050	1 *	VARIATOR SHAFT
7060	1 *	VARIATOR HOUSING
G6007	1 *	BALL BEARING
G6205	2 *	BALL BEARING
CP7060	1	VARIATOR HOUSING
7070	1	PULLEY
7080	1	WORM GEAR
7090	1	WORM GEAR HOUSING
7100	1	GEAR SHAFT
7110	1	WORM

5120	1	LOWER DOOR	7120	1	WHIRLING ARM
5140	1	UPPER DOOR	7200	1	* SPRING HOUSING
8111	1	CONTROL PLATE	7210	1	* SPRING
8372	1	VARIATOR INSTRUCTION	7220	1	* VARIATOR DISK, LOWER
8422	1	GEAR BOX INSTRUCTION	7230A	1	* VARIATOR DISK, LOWER
8712	1	INDICATOR PLATE	7260	1	* SHAFT HOUSING
8743	1	TILT INSTRUCTION	G6007	1	* BALL BEARING
9300	2	UPPER DOOR HINGE	G6204	1	* BALL BEARING
9310	6	HINGE	CP7260	1	SHAFT HOUSING COMPLETE
9500	4	SPRING PLATE	7290	1	SPEED CHANGE WHEEL SEAT
9590	2	HANDLE ARM	7300	1	PULLEY
9600	1	CHIP STOPPER	7310	1	SPEED READOUT DETECTOR <b>303264</b>
9700	1	INDICATE MIDDLE	7330	1	DIGITAL TACHOMETER <b>303238</b>
9780	1	BRUSHER BRACKET	9030	1	HANDWHEEL
9790	1	CHIP BRUSHER <b>303237</b>	BA44	-	V-BELT, 7071+7300 (60HZ)
9850	1	KEY FOR REAR DOOR	BA45	-	V-BELT, 7071+7300 (50HZ)
9880	1	CHIP COLLECTOR	BA43	-	V-BELT, 2011+7070
9999	1	EYE BOLT	BV875	1	V-BELT

#### CONTROL SWITCH COMPONENT

6245	1	VARIABLE TRANSFORMER
6600	2	PUSH BUTTON, ON, GREEN
6601	1	PUSH BUTTON, ON, WHITE
6602	1	PUSH BUTTON, OFF, RED
6603	2	PUSH BUTTON, ON/OFF, BLACK
6610	1	EMERGENCY SWITCH
6620	2	DOOR LIMIT SWITCH <b>303239</b>
6650	1	KEY SWITCH
6682	1	SELECT SWITCH
6700	1	MAIN POWER SWITCH
6713	1	MAGNETIC SWITCH <b>303254</b>
6723	1	OVERLOAD STARTER <b>303258</b>
6730	1	CONDENSER
6741	1	PILOT LAMP, GREEN
6745	1	VOLTAGE REDUCER <b>303266</b>
6752	4	FUSE SEAT
6753	1	FUSE SEAT
6754	1	FUSE SEAT
6717	3	POWER RELAY
6770	3	WIRE HOUSING
6771	1	GROUND SEAT
6774	1	WIRE HOUSING
6798	1	ELECTRIC BOX
6799	1	WIRING PLATE

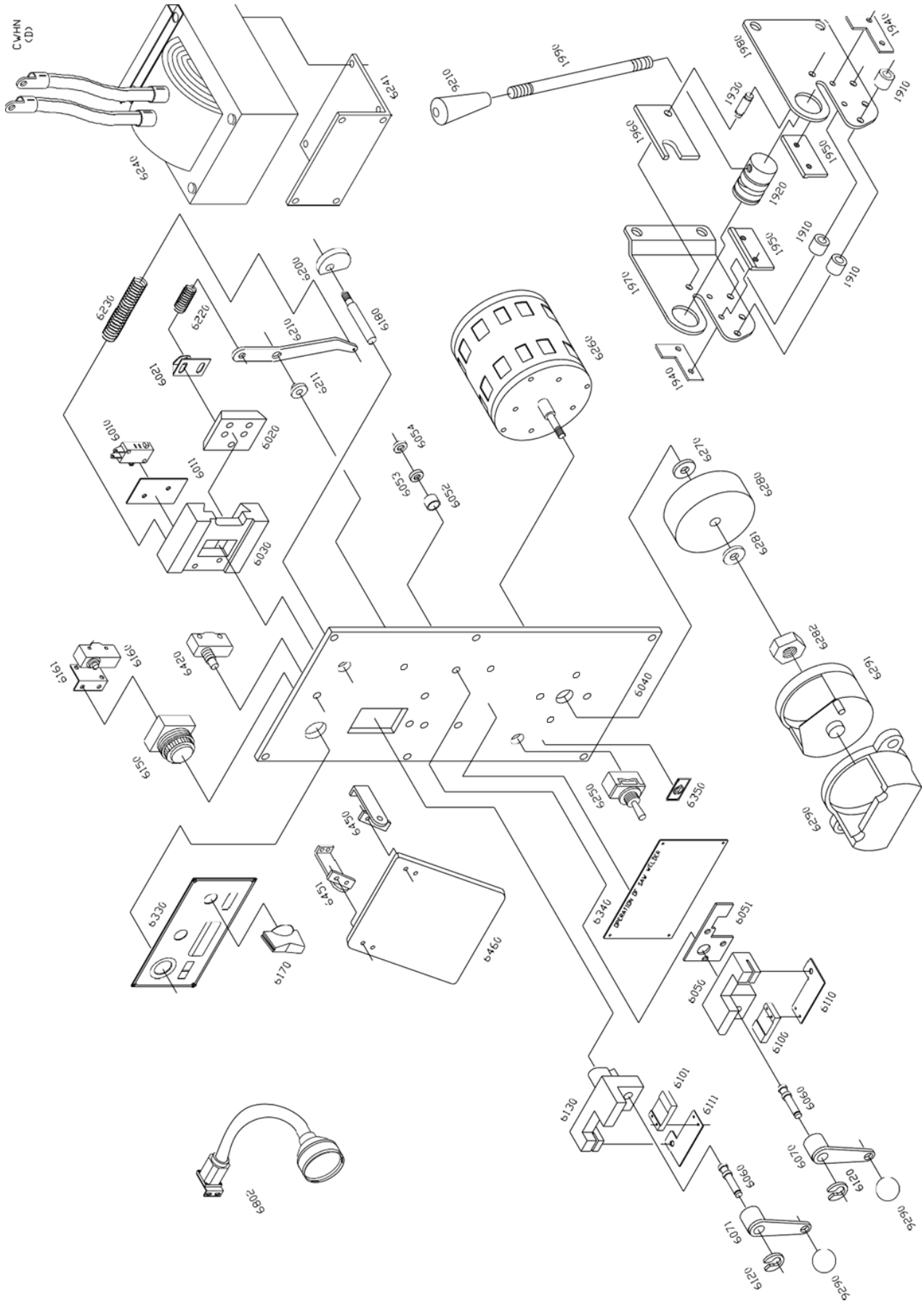

**WELDER  
COMPONENT  
T**

CVHN  
(D)

