

SCHEDULE OF ELECTRICAL EQUIPMENT		
Item.	Designation and function	Suppliers
A	DC DRIVER	
B	LINEAR SPEEDOMETER	
C	ON/OFF/SIGNAL SWITCH	
D	LOWER LIMIT SWITCH	
E	DC MOTOR	
F	VARIABLE RESISTANCE	
G	LIMIT SIGNAL	
H	EMERGENCY STOP SWITCH	
I	SOCKET	
J	HALL SENSOR	

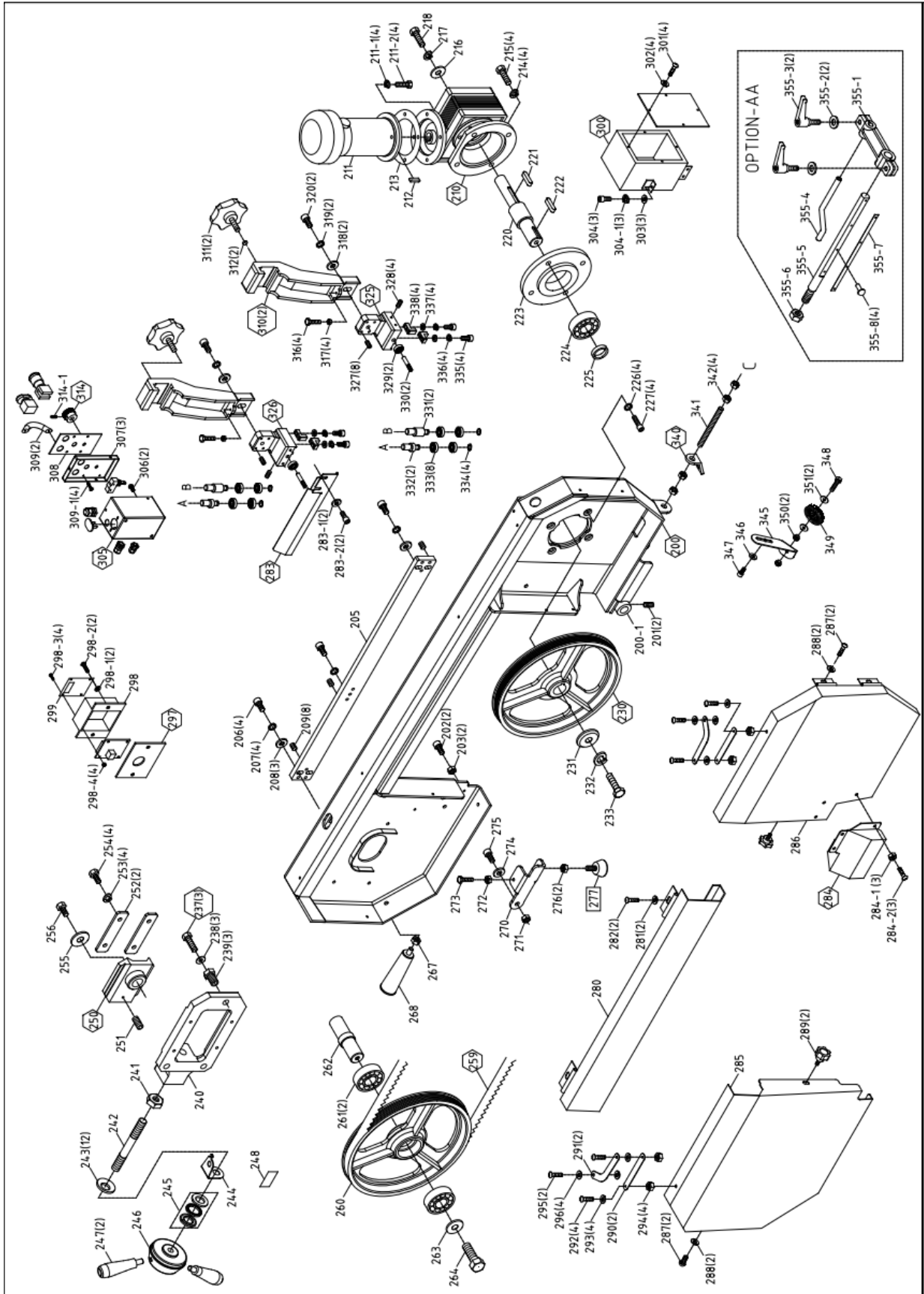

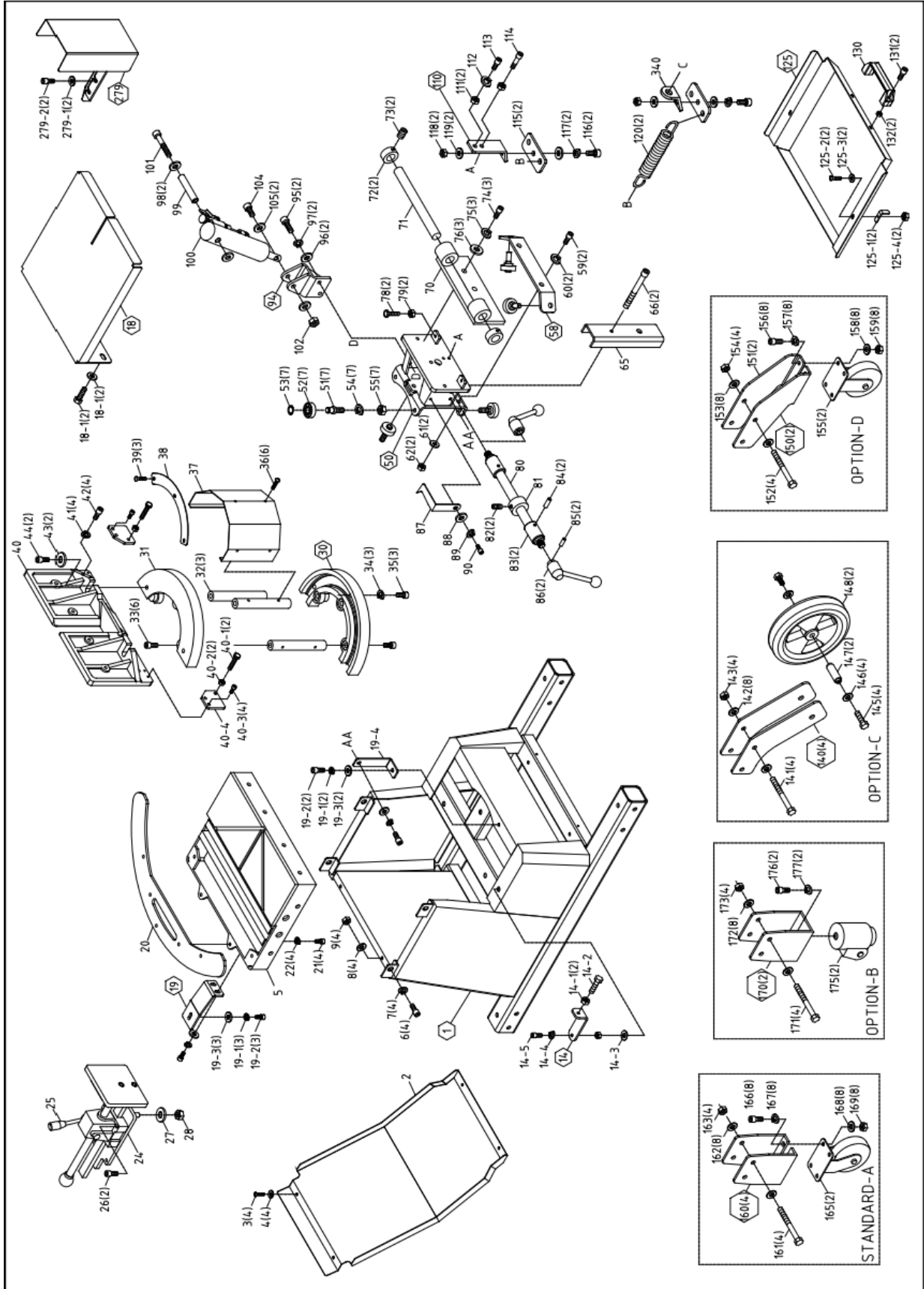

### EXPLODED VIEW & PARTS LIST

<u>Ref. No.</u>	<u>Part No.</u>	<u>Dake Part No.</u>	<u>Description</u>	<u>Specification</u>	<u>QTY</u>
1	163010		Stand		1
2	163010-2		Guide plate		1
3	MHS328		Hex Soc Screw	M6x16L	4
4	MW004		Washer	1/4"x19xt1.5mm	4
5	163015	304080	Vise base		1
6	MHS259		Hex Soc Screw	M10-1.5Px25L	4
7	HW106		Spring Washer	M10	4
8	MHW006		Washer	M10x20xt2	4
9	MHN006		Hex. Nut	M10	4
14	163067		Positioning bracket		1
14-1	MHN005		Hex. Nut	M8	2
14-2	MHS050		Hex. Head Screw	M8x40L	1
14-3	MW016	43632	Washer	5/16"x23xt2mm	1
14-4	MHW105		Spring Washer	M8	1
14-5	MHS244		Hex Soc Screw	M8x30L	1
18	163060		Vertical saw board		1
18-1	HS058	304009	Hex. Head Screw	M10x20L	2
18-2	MHW006	304010	Washer	M10x20xt2	2
19	163068A		Support		1
19-1	MHW105		Spring Washer	M8	5
19-2	MHS243		Cap Screw	M8x25L	5
19-3	MW016	43632	Washer	5/16"x23xt2mm	5
19-4	163068B		Support		1
20	163019	304082	Pallet		1
21	MHS328		Hex Soc Screw	M6x16L	4
22	HW104		Spring Washer	M6	4
23	Included in #25	Included in 303955 #25	Vise splint		1
23-1	Included in #25	Included in 303955 #25	Flat head socket head cap screws	M8x20L	2
24	163021	303955	Vise bottom plate		1
25	163020	303952	Pusher vise assembly	163065A	1
26	MHS247		Hex Soc Screw	M8x45L	2
	Pusher Vise Assembly	304061			
27	MW002	43634	Washer	1/2"x28xt2mm	1
28	MHN007	301134	Hex. Nut	M12	1
30	163013		Down plate		1
31	163012		Upper plate		1
32	163018		Axle column		3

<u>Ref. No.</u>	<u>Part No.</u>	<u>Dake Part No.</u>	<u>Description</u>	<u>Specification</u>	<u>QTY</u>
33	MHS260		Hex Soc Screw	M10x30L	6
34	MHS258		Hex Soc Screw	M10-1.5Px20L	3
35	HW106		Spring Washer	M10	3
36	MHS635		Cross hole screw	M5x10L	6
37	163014		Cover		1
38	163054	304150	Angle ruler		1
39	MHS635		Cross hole screw	M5x10L	3
40	163017		Fixed vise		1
40-1	MHS050		Hex Head Screw		2
40-2	MHN005		Hex Nut		2
40-3	MHS334		Hex Soc Screw		4
40-4	163140		Position Plate		2
41	HW106		Spring Washer	M10	4
42	MHS259		Hex Soc Screw	M10-1.5Px25L	4
43	MHW006		Washer	M10x20xt2	2
44	MHS261		Hex Soc Screw	M10x35L	2
50	163040		Slide Base		1
51	163039		Eccentric shaft		7
52	MCA6201ZZ		Ball bearing	12x32x10B	7
53	MHCS02		C-shaped buckle	S12	7
54	HW106		Spring Washer	M10	7
55	MHN006		Hex. Nut	M10	7
58	163042		Lower bracket		1
59	MHS259		Hex Soc Screw	M10x25L	2
60	HW106		Spring Washer	M10	2
61	MHW006		Washer	M10x20xt2	2
62	MHN006		Hex. Nut	M10	2
65	163043		Position bracket		1
66	MHS237		Hex Soc Screw	M6x55L	2
70	163041		Bow bracket		1
71	163048	304018	Support shaft		1
72	163045	304019	Locating ring		2
73	MHS240		Hex Soc Screw	M8x10L	2
74	MHS261		Hex Soc Screw	M10x35L	3
75	HW106		Spring Washer	M10	3
76	MHW006		Washer	M10x20xt2	3
78	MHS047		Hex. Head Screw	M8x25L	2
79	MHN005		Hex. Nut	M8	2
80	163046		Press Axle	S30C	1
81	163044		Eccentric ring	S45C	1
82	163082		Cup Point Screw	M8x10L	2
85	MHMO		Spring pin	5x30L	2

<u>Ref. No.</u>	<u>Part No.</u>	<u>Dake Part No.</u>	<u>Description</u>	<u>Specification</u>	<u>QTY</u>
86	163073		Handle	M16	2
87	163053		Zero Pointer		1
88	MWM		Washer	1/4"x19xtl .5mm	1
89	HWI104		Spring Washer	M6	1
90	MHS328		Hex Soc Screw	M6x16L	1
94	163036	304020	Cylinder bracket		1
95	MHS243		Hex Soc Screw	M8X25L	2
96	MW016	43632	Washer	5/1 6"x23xtlmm	2
97	MHN005		Hex. Nut	MS	2
98	MW016	43632	Washer	5/1 6"x23xtlmm	2
99	163069		Bushing		1
100	181304BT		Hydraulic Cylinder		1
101	MHS269		Hex Soc Screw	M10x75L	1
102	MHN006		Hex. Nut	M10	1
104	MHS262		Hex Soc Screw	M10x40L	1
105	MHW006		Washer	M10x20xt2	2
110	163055		Bracket		1
111	MHN005		Hex. Nut	M8	2
112	MHW105		Spring Washer	M8	2
113	MHS243		Hex Soc Screw	M8x25L	2
114	MHS246		Hex Cap Screw	M8-40L Half Tooth	1
115	163056		Bracket		2
116	MHS259		Hex Soc Screw	M10- 1.5Px25L	2
117	HW106		Spring Washer	M10	2
118	MHN006		Hex Nut	M10	2
119	MHI323		Washer	M10	2
120	163027	304021	Tension Spring		2
125	163010-1		Shredding Groove		1
125-1	163010-3		Baffle		2
125-2	MHS637		Cross hole screw	M6x15L	2
125-3	MW025		Washer	1/4" x 19 x 1.5mm	2
125-4	MHN004		Hex Nut	M6	2
130	1965052		Handle		2
131	MHS242		Hex Soc Screw	M8x20L	2
132	MHN005		Hex. Nut	M8	2
140	163032	304032	Wheel Bracket		4
141	HS072		Hex Head Screw	M10x90L	4
142	MHW006		Washer	M10x20xT2	8
143	MHN006		Hex Nut	M10	4
145	MHS045		Hex Head Screw	M8x15L	4

<u>Ref. No.</u>	<u>Part No.</u>	<u>Dake Part No.</u>	<u>Description</u>	<u>Specification</u>	<u>QTY</u>
146	MW013	304034	Washer	3/8"x20xt2mm	4
147	163062		Wheel Axle		4
148	163035	304033	Wheel		4
150	163032A-1		Wheel bracket		2
151	163032A-2		Wheel bracket		2
152	HS072		Hex. Head Screw	M10x90L	4
153	MHW006		Washer	M10x20xt2	8
154	MHN006		Hex. Nut	M10	4
155	163034A		Wheel		2
156	MHS243		Hex Soc Screw	M8x25L	8
157	MHW105		Spring Washer	M8	8
158	MW016	43632	Washer	5/16"x23xt2mm	8
159	MHN005		Hex. Nut	M8	8
160	163033		Wheel bracket		4
161	HS072		Hex. Head Screw	M10x90L	4
162	MHW006		Washer	M10x20xt2	8
163	MHN006		Hex. Nut	M10	4
165	163034		Wheel		2
166	MHS243		Hex Soc Screw	M8x25L	8
167	MHW105		Spring Washer	M8	8
168	MW016	43632	Washer	5/16"x23xt2mm	8
169	MHN005		Hex. Nut	M8	8
170	163033A	304035	Wheel bracket		2
171	HS072		Hex. Head Screw	M10x90L	4
172	MHW006		Washer	M10x20xt2	8
173	MHN006		Hex. Nut	M10	4
175	163035A	304038	Wheel		2
176	MHS280		Hex Soc Screw	M12x30L	2
177	MW201		Spring Washer	M12	2
200	163005		Saw bow		1
200-1	163049		Bow Pivot		1
201	MHS240		Cap Screw	M8x10L	2
202	MHS328		Cap Screw	M6x16L	2
203	MHN004		Hex. Nut	M6	1
205	163031		Slide rail		4
206	MHS244		Cap Screw	M8x30L	4
207	MHW105		Spring Washer	M8	4
208	MW016	43632	Washer	5/16"x23xt2mm	6
209	MHS430		Hex. Headless Screw	M8x10L	1
210	163074	304022	Gear Box	E=1/40	1
211	MDV10509-3	303956	Motor	1.5HP-230V-1PH	4
211-1	HW104		Spring Washer	M6	4



<u>Ref. No.</u>	<u>Part No.</u>	<u>Dake Part No.</u>	<u>Description</u>	<u>Specification</u>	<u>QTY</u>
211-2	MHS034		Hex. Head Screw	M6x20L	1
212	HK114		Key	6*6*40	1
213	198214	304023	Gasket		4
214	MHW106		Spring Washer	M10	4
215	MHS059	78758	Hex. Head Screw	M10x25L	1
216	198037		Drive Shaft Washer		1
217	HW106		Spring Washer	M10	1
218	MHS059	78758	Hex. Head Screw	M10x25L	1
220	163023	304185	Drive shaft		1
221	HK091		Round Head Key	8X7X50	1
222	HK044		Key	7x7x30L	1
223	163024		Main flange		1
224	MCA6206LLU		Bearing	6206	1
225	163022		Back ring		4
226	MHS259		Hex Soc Screw	M10-1.5Px25L	4
227	HW106		Spring Washer	M10	1
230	189016	304024	Drive Wheel		1
231	198037		Drive Shaft Washer		1
232	HW106		Spring Washer	M10	1
233	HS058		Hex. Head Screw	M10x20L	3
237	HS066		Hex. Head Screw	M10-1.5Px60L	3
238	MHW106		Spring Washer	M10	3
239	189054		Screw		31
240	189050		Tension		1
241	MHN008		Hex. Nut	M16	1
242	198026	303855	Leadscrew		1
243	198093		Spring Washer	ID16.3 x OD31.5 x T1.8	12
244	189053	304151	Tension Indication Ring		1
245	CA51203	304152	Bearing	51203	1
246	198051A	304153	Blade Tension Handle		1
247	198086J	304154	Knob		2
248	163071		Tension Scale		1
250	189051		Anchor Block		1
251	HS423	304107	Hex. Headless Screw	M6-1.0Px15L	1
252	189052		Press Board		2
253	MHW105		Spring Washer	M8	4
254	MHS240		Hex Soc Screw	M8x10L	4
255	121011		Washer		1
256	MHS242		Hex Soc Screw	M8x20L	1
259	163011	304059	Blade	0.9X27X2997mm	1

<u>Ref. No.</u>	<u>Part No.</u>	<u>Dake Part No.</u>	<u>Description</u>	<u>Specification</u>	<u>QTY</u>
260	189017	303903	Idler Wheel		1
261	CA6205LLU		Bearing	6205	2
262	163030		Shaft		1
263	121011		Washer	6mm	1
264	HS046		Hex. Head Screw	M8-1.25Px20L	1
267	MHN006		Hex. Nut	M10	1
268	189033	304155	Handle		1
270	163029	304156	Lower limit bracket		1
271	MHN006		Hex. Nut	M10	1
272	MHN005		Hex. Nut	M8	1
273	HS046		Hex. Head Screw	M8x20L	1
274	MHW006		Washer	M10x20xt2	1
275	MHS259		Hex Soc Screw	M10-1.5Px25L	1
276	MHN005		Hex. Nut	M8	2
277	189087		Lower limit screw		1
279	163070		Vertical saw cover		1
279-1	MW004	81938	Washer	1/4"x19xt1.5mm	2
279-2	MHS328	302396	Cap Screw	M6x16L	2
280	163008		Middle cover		1
281	MW004		Washer	1/4"x19xt1.5mm	2
282	MHS637		Cross hole screw	M6x15L	2
283	163063	304060	Side Blade Cover		1
283-1	MW004	81938	Washer	1/4"x19xt1.5mm	2
283-2	MHS259	78758	Hex Soc Screw	M10-1.5Px25L	2
284	163064	304158	Main Blade cover		1
284-1	MHN004		Hex. Nut	M6	3
284-2	MHS637		Cross hole screw	M6x15L	3
285	163007		Side cover		1
286	163006		Main Cover		1
287	MHS637		Cross hole screw	M6x15L	4
288	MW004		Washer	1/4"x19xt1.5mm	4
289	103127	304005	Knob	M6-1.0Px10L	2
290	163009-1	304157	Board A		2
291	163009-2	304160	Board B		2
292	MHS635		Cross hole screw	M5x10L	4
293	MW049		Washer	3/16"x12xt1mm	4
294	MHN003		Hex. Nut	M5x10L	4
295	MHS637		Cross hole screw	M6x15L	2
296	MW004		Washer	1/4"x19xt1.5mm	4
297	163066		Pad		1
298	151187		Speed Indicator Dial Cover		1

<u>Ref. No.</u>	<u>Part No.</u>	<u>Dake Part No.</u>	<u>Description</u>	<u>Specification</u>	<u>QTY</u>
298-1	HW004B		Flat Washer	M6	2
298-2	MHT001		Hex Soc Screw	M5-0.8Px10L	2
298-3	MHS504		Round Hd. Screw	M3X15L	4
298-4	MHN001		Hex Nut	M3	4
299	151197		Speed Plate		1
300	163052	304159	Electrical box		1
301	MHS635		Cross hole screw	M5x10L	4
302	MW049		Washer	3/16"x12xt1mm	4
303	MW004		Washer	1/4"x19xt1.5mm	3
304	MHS328		Cap Screw	M6x16L	3
305	163050	304161	Operation Box		1
305-1	MET21AK				1
306	MHS637		Cross hole screw	M6x15L	2
307	MHS635		Cross hole screw	M5x10L	3
308	PJNB631136E		Panel Sticker	164 mm X 94 mm	1
309	163061		Handle		2
309-1	MHS626		Cross hole screw	M4x8L	4
310	163025	304025	Arm Seat		2
311	1965015-1	304026	Blade Adjustable Knob	M10x50L	2
312	260158		Copper gasket	D8x3mmL	2
314	272048		Speed Button		1
314-1	HS408		Hex. Headless Screw	M4x8L	1
316	MHS034		Hex. Head Screw	M6x20L	4
317	MHN004		Hex. Nut		4
318	MHW006		Washer	M10x20xt2	
319	HW106		Spring Washer	M10	2
320	MHS259		Cap Screw	M10x25L	2
325	189015	304162	Bearing Bracket (Right)		1
326	189014	304163	Bearing Bracket (Left)		1
327	HS422		Hex. Headless Screw	M6-1.0Px10L	8
328	HS422		Hex. Headless Screw	M6-1.0Px10L	4
329	CA6082RS		Bearing	608-2RS	2
330	121061	304164	Bearing Shaft		2
331	189019	304165	Eccentric Guide		2
332	189018	304166	Eccentric Guide		2
333	CA6082RS		Bearing	608-2RS	8
334	HCS39		C-Retainer	8	4
335	HS230		Hex. Head Screw	M6-1.0Px20L	4
336	HW004		Washer	6.5x13x1mm	4

<u>Ref. No.</u>	<u>Part No.</u>	<u>Dake Part No.</u>	<u>Description</u>	<u>Specification</u>	<u>QTY</u>
337	HW104		Spring Washer	M6	4
338	103120	304044	Carbide Guide		4
340	163057		Screw Plate		1
341	163059		Screw Rod		1
342	MHN007		Hex. Nut	M12	4
345	163038		Brush Bracket		1
346	MW004		Washer	1/4"x19x1.5mm	1
347	MHS328		Cap Screw	M6x16L	1
348	HS037		Hex. Head Screw	M6-1.0Px35L	1
349	191334A		Brush		1
350	MHN004		Hex. Nut	M6	2
351	MW004		Washer	1/4"x19x1.5mm	2
355-1	198057		Distance Set Bracket		1
355-2	HW005		Washer	M8	2
355-3	198088		Muti directional Handle		2
355-4	198058		Distance Set Rod		1
355-5	121059N		Distance Set Rod		1
355-6	HN010		Hex. Nut	M14xP1.5	2
355-7	198087		Scale		1
355-8	HH001		Rivet	2	4

***Please contact factory for current prices.***

## ORDERING INFORMATION

Parts are available for direct purchase from Dake or through a distributor. When placing a parts order, you will need to provide the part number, name of part, and model number. All parts shipped F.O.B. Factory in Grand Haven, MI.